

What are TruckWings?

TruckWings™ are an active aerodynamic device that automatically closes the gap between the cab and the trailer while the truck is operating at highway speeds to reduce drag, improve handling, and save fuel.



Scan QR code
to see
TruckWings
video in action
& learn more

How do they Work?

TruckWings open automatically and require no driver input to deploy.

When a trailer is hooked up, the panels will auto-deploy at speeds above 52 mph. The panels immediately retract against the cab when speed drops below 50 mph in time for turns.

How are TruckWings controlled?



TruckWings are designed to be fully automatic. The in-dash controller reads vehicle speed and trailer distance to automatically send a signal to deploy or retract the TruckWings.

Leave the toggle cover closed for automatic operation.

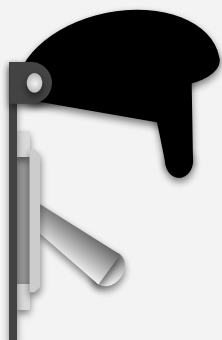

Toggle Position	Operation Modes - TruckWings Controller
	Test Mode: ⚠️ Ensure the catwalk is clear before engaging Test Mode. Manually open Panels <i>only</i> if no trailer is detected and truck is stopped.
	Service Mode Panels are manually retracted at all speeds.
	Auto Mode - Driver Default Setting Leave in down position with switch cover closed for auto-deployment.

XS-TD22001 REV A

Important Inspection Points

For Full TruckWings PMI Checklist, please refer to *TruckWings Maintenance & Use Guide*

1. Inspect panels for signs of damage, missing rivets or loose hardware.
2. Lift up and down on panels to make sure there is no excessive play in the hinge bushings.
3. Inspect distance sensor for any signs of damage and alignment is directly facing trailer.
4. Inspect cylinders for wear or corrosion and listen for air leaks at air connections and control valve.

Need more help troubleshooting or ordering parts?

Scan QR code to see online *TruckWings Troubleshooting & Repair Guides* or contact TruckLabs Technical Support.

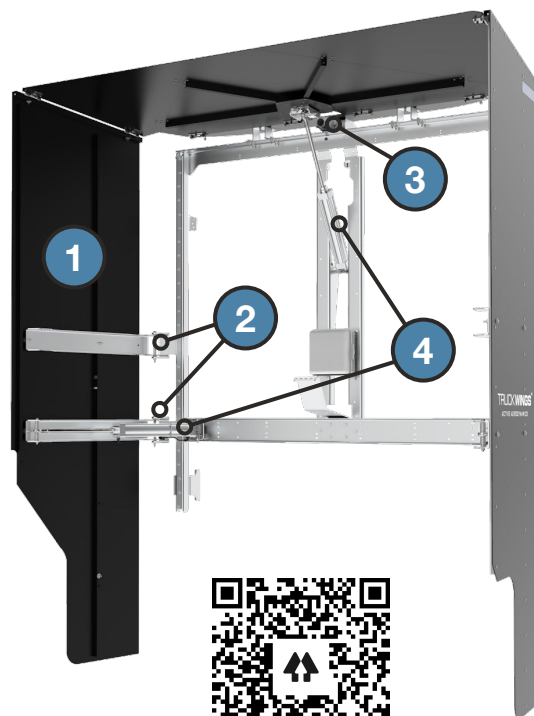

Scan for Service Info



WARNING



IN CASE OF SERVICE, SYSTEM MUST BE DEACTIVATED BEFORE ACCESSING AREA BETWEEN TRUCKWINGS AND BACK OF CAB.

FAILURE TO FULLY DEACTIVATE SYSTEM CAN LEAD TO SERIOUS INJURY INCLUDING PINCHING, ENTRAPMENT, AND CRUSHING.

Deactivating TruckWings for Service

1. Turn ignition off and remove key. Leave the controller in **Auto Mode**. Drain the truck air tanks to 0 psi by pumping brake pedal.
2. If service requires the TruckWings to be deployed, disconnect an air line on one of the lower cylinders and pull the panels open.
3. Using a small ladder for access, push the top panel up by hand and lock in place using Service Tool XS-010782-1.

Reactivating TruckWings

1. Reconnect any air lines to the actuator(s) and ensure the area is clear behind the cab. Turn on the truck to restore air pressure.
2. Open and close the system using the toggle to go between **Test Mode** and **Service Mode** to check for normal operation.
3. Leave the toggle switch on the controller to **Auto Mode** by closing the toggle cover.

XS-TD22001 REV A